

REVISION RECORD				
REV	ECO	DESCRIPTION	DRFT	CHKD

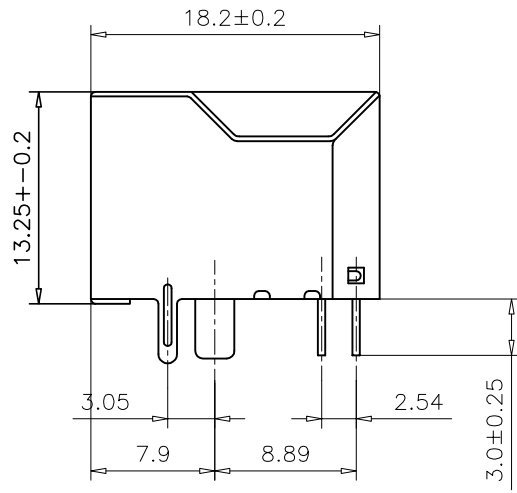
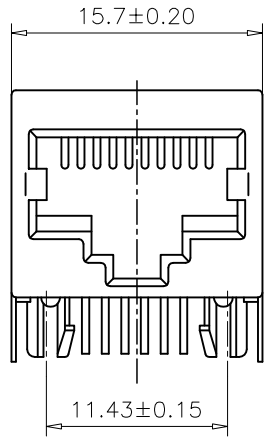

NOTES:

MATERIAL :

- 1.HOUSING MATERIAL :GLASS FILLED POLYESTER UL94V-0.
- 2.CONTACT MATERIAL :PHOSPHOR BRONZE $\phi 0.45\text{mm}$.
- 3.PLATING :GOLD PLATING OVER NICKEL.
- 4.SHIELD :0.20mm THICKNESS COPPER ALLOY WITH NICKEL PLATED.

ELECTRICAL:

- 1.VOLTAGE RATING :125 VAC RMS.
- 2.CURRENT RATING :15 AMP.
- 3.CONTACT RESISTANCE :30 MILLIOHMS MAX.
- 4.INSULATION RESISTANCE :500 MEGOHMS MIN @ 500V DC .
- 5.DIELECTRIC WITHSTANDING RESISTANCE :1000V AC RMS 50Hz. 1MIN.

MECHANICAL:

- 1.DURRABILITY :750 CYCLES MIN.
- 2.PCB RETENTION PRE-SOLDER :1 LB MIN.

ENVIRONMENTAL:

- 1. STORAGE : -40°C~+85°C
- 2. OPERATION : 0°C TO 70 °C

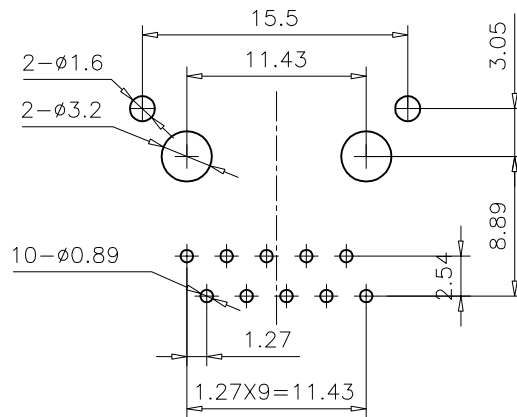
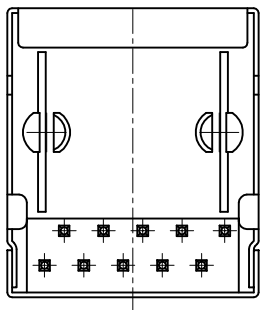

PC Board Layout
Component Side Shown

	DFTO: SHB	DATE: 2007.05.03	<h1>Coorle Technology</h1>	
	CHKD: LANBO	DATE: 2007.05.03		
	MFO:	DATE:	TITLE 5621-1*1-10P100-S-F3.05	
	APPVL:	DATE:		
MATERIAL :		QT'Y :		DRAWING NO. TES6A1002 /PART NO.
FINISH :		SCALE :		
DO NOT SCALE DRAWING			SHEET X OF Y	